



# NORTHERN CALIFORNIA FAIR DERBY DOG DASH

## ALL SMALL BREED DOGS & MIXES

Dear Dog Owners,

Thank you so much for entering the 2011 Derby Dog Dash at The Big Fresno Fair on Saturday, October 15, 2011.

The first dog race will go off at approximately 2:15 p.m. There will be 6 heats and one Championship Race. The top two finisher from each heat will advance to the Championship Race (at approx. 5:15 pm.).

A total of 12 dogs will compete in the Championship heat. The number of dogs in each heat depends on the number of entries.

The winner of each heat will receive \$30 and the second place finisher will receive \$20. The first place winner of the Championship Race will receive \$100 and second \$50. **You will receive two FREE Admission Passes to the Fair per entry.** Each additional admission to the Fair is \$10 for Adults, \$7 for Seniors 62+, \$7 for Children 6-12 and free to Children under 6. Parking is \$8/\$5 per vehicle for general parking (Butler Ave., Infield Lots and Maple Lot). There is Preferred VIP Parking on Chance Ave. for \$12.

The Big Fresno Fair hours are 10:30 a.m. to Midnight. You must have your dog on a leash at all times while on Fairground property and cannot enter any Livestock areas or Exhibit Halls with your dog.

**You will receive two FREE Admission Passes per entry.** Please pick your free passes up at Will Call which is located in the Ticket Box Office off of Chance Avenue.

The Fairgrounds is located at:  
Big Fresno Fair  
1121 South Chance Ave.  
Fresno, CA 93702  
(559)650-FAIR

The Derby Dog Dash races will be held at the Racing Grandstand on the Fairgrounds (the Brian I. Tatarian Grandstand on the map). The Derby Dog Dash registration booth will be located on the bottom level, inside the Grandstand and all the way on the North hand side of the structure (to your left if you are facing the Grandstand).



Ground floor admission in the Grandstand is free. Please feel free to bring your own chairs. Reserved or box seats are available for reservation by phone at (559) 650-FAIR. Coolers and food are not permitted on the Fairgrounds.

We will have water available for your dogs. Feel free to bring your own bowl or use community bowls that we will provide.

Entrants and exact race times will be posted the evening of Friday, October 14 at [www.DerbyDogDash.com](http://www.DerbyDogDash.com).

Attached is a map to the Fairgrounds. Please check-in at the registration booth at least 25 minutes prior to your race. Please check in for your individual race at least 15 minutes prior to the running.

Thank you so much for your participation and we look forward to seeing you on Saturday, October 15!

Saturday  
October 15, 2011

## DERBY DOG DASH

Post Time 2:15 PM

### Heat 1 - After Horse Race #5 (2:15 p.m.)

Dog	Weight	Owner	Breed
1 Piper	16	Linden Manelski	Jack Russell Terrier
2 Dori	14	Amanda Bernardi	Chiweenie
3 Princess	14	Charles Chester	Dachshund
4 Saydee	17	Hortencia Maldonado	Pekingese
5 Ebony	13	Dulces Gonzalez	Chihuahua Terrier Mix
6 Buddy	15	Fallon Pratt	Dachshund Terrier Mix
7 Kusu	15	Billy Lewis	Jack Russell Terrier
8 Heidi	15	Anthony & Melanie Lema	Miniature Schnauzer
9 Sullivan	14	Ella Pike	Dachshund
10 Boots	17	Jon Dominguez & Nicole Treesh	Mini-Pinscher Mix

### Heat 2 - Horse Race #6 (2:45 p.m.)

Dog	Weight	Owner	Breed
1 Dash	12	Rudy Lucio Jr.	Dachshund Terrier Mix
2 Shrimp	10	Judy McDonough & Greg Jines	Rat Terrier Mix
3 Sami	12	Cody & Ashley Jones	Boston Terrier
4 Kosmo	11	Aphivanh Xayavath	Chihuahua Terrier Mix
5 Blackspot	10	Mario Volpa	Jack Russell Terrier Mix
6 Suzie	11	Michael Lenzini	Jack Russell Terrier
7 Lil Man	12	Lisa Martinez	Chihuahua Mix
8 Sadie	8	Raul Vera	Manchester Terrier
9 Dodger	7	Maricella Villarreal	Yorkshire Terrier
10 Duke	12	Jenny Ruiz	Mini-Pinscher
11 DeDe	12	Gayle O'Bannon	Doxie Poodle Mix

### Heat 3 - Horse Race #7 (3:15 p.m.)

Dog	Weight	Owner	Breed
1 Rosey	19	Terri Eaton	Rat Terrier
2 Pepper	20	Becky Balistreri	Schipperke
3 Borregita	18	Guillermina Garcia de Mena	Toy Poodle
4 Jack	19	Francisco Maldonado	Jack Russell Terrier
5 Tagus	18	JoDe Collins	Border Terrier
6 Shorty	15	Lisa Dezotell	Pomeranian Mix
7 Ziggy	18	Bridget Barnes	Chihuahua Doxie Mix
8 Scooter	20	Monica & Kest Cousins	Chihuahua Doxie Mix
9 Dottie	19	Dorraine Smith	Jack Russell Terrier

### Heat 4 - Horse Race #8 (3:45 p.m.)

Dog	Weight	Owner	Breed
1 Fufu	4	Toni Noguez	Chihuahua
2 Maggie	7	Andrew Duke	Chihuahua Mix
3 Bolt	7	Selena Reyes & Eric Sanchez	Chihuahua
4 Leonardo	4	Megan Noguez	Chihuahua
5 Duke	7	Shannon Hadden	Chihuahua
6 Parker	6	Anne & Craig Sturrock	Chihuahua
7 Kitty	3	Clarita Martinez	Yorkshire Terrier
8 Pee Wee	5	Savannah Ayala	Chihuahua
9 Scooby Dudette	6	Jose Rodriguez	Chihuahua Mix
10 Rose	5	Monica & Kest Cousins	Chihuahua Poodle Mix

**Heat 5 - Horse Race #9 (4:15 p.m.)**

	Dog	Weight	Owner	Breed
1	Milo	23	James & Antonea Phillips	Dachshund
2	Buster	15	Tami Nabors	Dachshund
3	Emilio	9	Jacqueline Moreno	Dachshund
4	Harley	13	Alex Avila	Dachshund
5	Billy	14	Ella Pike	Dachshund
6	Tofu	12	Sara Lopez	Dachshund
7	Toby	17	John & Debbie Stjerive	Dachshund
8	Buddy	9	Jessica Duarte	Dachshund
9	Lily	12	Fallon Pratt	Dachshund
10	Panini	6	Charles Chester	Dachshund

**Heat 6 - Horse Race #10 (4:45 p.m.)**

	Dog	Weight	Owner	Breed
1	Iggy	25	Diana Skinner	Toy Poodle
2	Sonora	27	Sandy Torok	Mini-Aussie Shepard
3	Epi	24	Major Rogers	French Bulldog
4	Molly	21	Kayla Myers	Toy Poodle
5	Camouflage	25	Terri Eaton	Rat Terrier
6	Ripcord	25	Brad Patterson	Corgi & Rat Terrier Mix
7	Jackie	25	Shoua Vue	Wheaton Mix
8	Leelu	25	Scott & Katrina Yokoyama	Pembroke Welsh Corgi
9	Beto	28	Jonathan Ota	Shepard Mix

**Championship Race - After Horse Race #11 - 5:15 p.m.**

1st and 2nd Place Winners from Each Heat

## **2011 DERBY DOG DASH PROCEDURES**

### **Entries consist of:**

- 1) Completed "Official Entry Form"
- 2) Signed Release and Waiver of Liability Agreement
- 3) Photograph of your dog (e-mail to [admin@calfairs.net](mailto:admin@calfairs.net) and [heather@calfairs.net](mailto:heather@calfairs.net))
- 4) Refundable \$20 deposit, in the form of a check, is required per dog per race. The check/deposit holds a spot for your dog and will be returned when the dog races on race day. The deposit will NOT be returned if the dog fails to run on race day. The dog's name needs to be on the check. Make check out to: California Authority of Racing Fairs. Mail checks to: Derby Dog Dash, c/o California Authority of Racing Fairs, 1776 Tribute Road, Suite 205, Sacramento, CA, 95815. Checks must be mailed 5 days prior to the race.

The winner of the Championship heat will win \$100 and the second place winner in the Championship Heat will win \$50. The winner of each individual heat will win \$30 and second place will receive \$20. Each entry will include 2 free passes to the Fair.

The races in the 2011 Derby Dog Dash Series include:

- Pleasanton – Saturday, July 2, 2011
- Pleasanton – Saturday, July 9, 2011
- Santa Rosa – Sunday, July 31, 2011
- Santa Rosa – Sunday, August 7, 2011
- Santa Rosa – Sunday, August 14, 2011
- Fresno – Saturday, October 15, 2011

## **PLEASANTON, SANTA ROSA & FRESNO**

Each dog will run in one preliminary heat. The winner of each heat will compete in the Championship race.

There will be a MAXIMUM of 9 preliminary heats. If there are fewer than 108 entries, the number of heats will be adjusted accordingly.

The number of dogs in each heat will depend on the number of entries, with a MAXIMUM of twelve dogs per heat.

If entries exceed 108 dogs, owners will be limited to two dogs per human competitor. Owners are encouraged to enter as many dogs as possible. If we are not able to accommodate more than two dogs per owner, we will contact the owner by phone to determine which two dogs the owner would like to run.

If more than 108 entries are received for the Derby Dog Dash, contestants will be selected on a first-come, first-served basis. If you submit an application for a dog and we have already received 108 applications, we will contact you by e-mail to let you know that your dog will not be able to compete. If fewer than 108 entries are received, every attempt will be made to place an equal number of dogs in each heat.

**Two handlers are required per dog:** one handler remains with the dog behind the starting line, the other handler will stand behind the finish line to call the dog and collect him/her after the race. At least one handler must be 18 years of age or older.

For the safety of the dogs, **handlers are not permitted to leave their designated places while the dogs are competing.**

We will not be using a starting gate. Owners will stand at the starting line and hold their dog. Once the dogs are settled behind the starting line, the track announcer will state “Ready, Set, Go” and the handlers will release the dog. Please allow your dog to run freely from the starting line of his/her own accord. ANY HANDLER RELEASING THE DOG BEFORE “GO” WILL BE DISQUALIFIED AT THE DISCRETION OF THE RACING OFFICIALS.

Once the announcer has said “GO” and the dog has been released, finish-line handlers are to call their dogs across the finish line and into the receiving area. You may use snacks, squeaky toys, etc. to coax your dogs. Loud noisemakers, live animals other than dogs, and anything deemed to be disruptive to other dogs will not be permitted. **In order to be declared the winner, all 4 paws must cross the finish line.**

Once the first dog (with all four paws) has crossed the finish line, the handlers of the other dogs are requested to continue to call their dogs until all dogs are with their respective owners. If your dog does not come to you within a reasonable amount of time after the finish of the race (determined by the Racing Official), you will be allowed to enter the course and collect your dog. **Please be careful, and do not interfere with anyone else’s dog.**

Dogs will be issued a colored jacket that will correspond with their starting position. All dogs must wear the jacket. If a dog cannot wear the jacket, the dog will not be allowed to start.

The Championship Heat will consist of the 1<sup>st</sup> place winners of all the previous heats and possible “wild-card” spots. The procedures for the final heat will be the same as above.

Racing Officials will determine the winners. Decisions regarding placing by Racing Officials are final.

Racing Officials will determine 1st place winners. Decisions of the Racing Officials are final.

The winner of the Derby Dog Dash Championship and his/her owner and handlers will come to the winner’s circle on the racetrack for photos.

Management reserves the right to interpret all questions and conditions in regard to this event, without claim for damages or recourse of any kind. All questions and definitions not covered explicitly in these rules will be decided by the management of the Alameda County Fair, Sonoma County Fair, Big Fresno Fair and the California Authority of Racing Fairs with those decisions being final.

Dogs MUST BE kept on LEASHES at all times while on Fairground property (the only exception being when the dog is racing). Violators will be asked to leave the property. No exceptions.

All dogs must meet the weight and height requirement (less than 28 lbs AND 15” at the shoulder). Dog may be weighed and measured at the discretion of the Racing Officials. The Racing Officials will disqualify any dog that does not meet these requirements. The dogs can be pure-bred or mixed. Every effort will be made to run dogs of similar breeds and weights in the same heats.

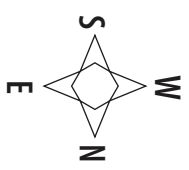
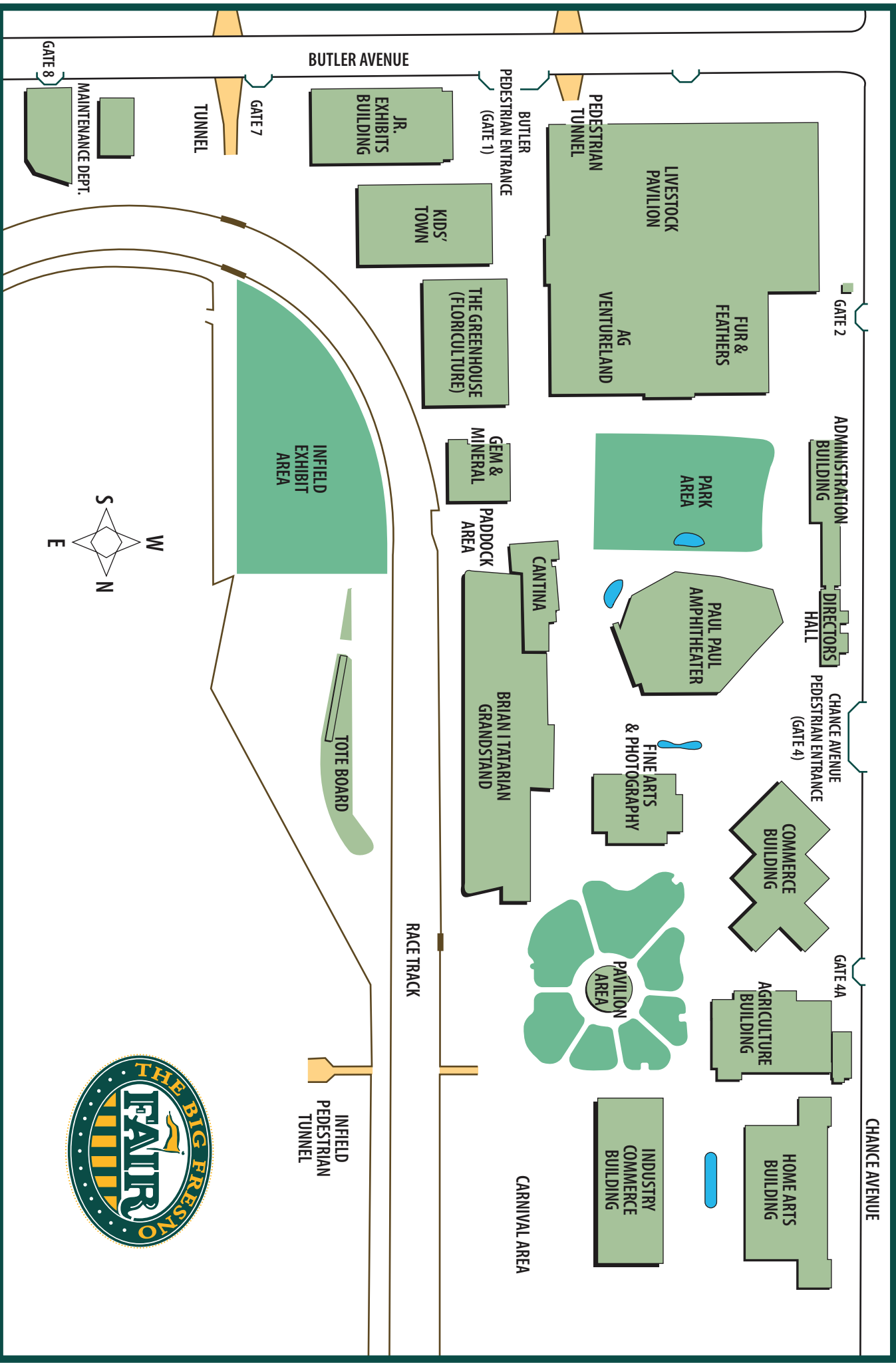

CHANCE AVENUE

GATE 2

GATE 4A

GATE 4

BUTLER AVENUE

BUTLER PEDESTRIAN ENTRANCE (GATE 1)

RACE TRACK

INFIELD PEDESTRIAN TUNNEL

TUNNEL

GATE 7

GATE 8

MAINTENANCE DEPT.

CHANCE AVENUE

ADMINISTRATION BUILDING

DIRECTORS HALL

CHANCE AVENUE PEDESTRIAN ENTRANCE (GATE 4)

COMMERCE BUILDING

AGRICULTURE BUILDING

HOME ARTS BUILDING

INDUSTRY COMMERCE BUILDING

LIVESTOCK PAVILION

AG VENTURELAND

FUR & FEATHERS

PARK AREA

PAUL PAUL AMPHITHEATER

FINE ARTS & PHOTOGRAPHY

PAVILION AREA

CARNIVAL AREA

GEM & MINERAL PADDOCK AREA

CANTINA

BRIAN I TATARIAN GRANDSTAND

THE GREENHOUSE (FLORICULTURE)

KIDS' TOWN

JR. EXHIBITS BUILDING

INFIELD EXHIBIT AREA

TOTE BOARD